

# TUBE END MILLING UNIT

Made in Germany

- High cutting capacity
- Quick and secure clamping
- Rugged and compact type of construction
- Easy handling
- Low price at high quality



**MF3-R**

## Field of application

The unit serves to machine and prepare welding edges on tubes, branches and headers. Having a low weight the unit is of very rugged design. Operated by one man only, it is well suited for use in the workshop and on site. Due to its extremely compact type of construction it can be readily used in confined space. Its high working speed and quick readiness allow economical manufacturing.

# TECHNICAL DATA

## Working range:

Tube outside diameter:	min. 12,0 mm
	max. 44,5 mm
Tube wall thickness:	max. 10,0 mm
Spindle stroke:	15,0 mm
Form of weld:	I, V or special form

## Compressed air gear motor:

Power:	740 W at 6 bar
Air consumption:	0,96 m <sup>3</sup> /min
Compressed air connection:	R 1/4"
Feed:	manual
Weight:	4,8 kg

## FORM OF WELD

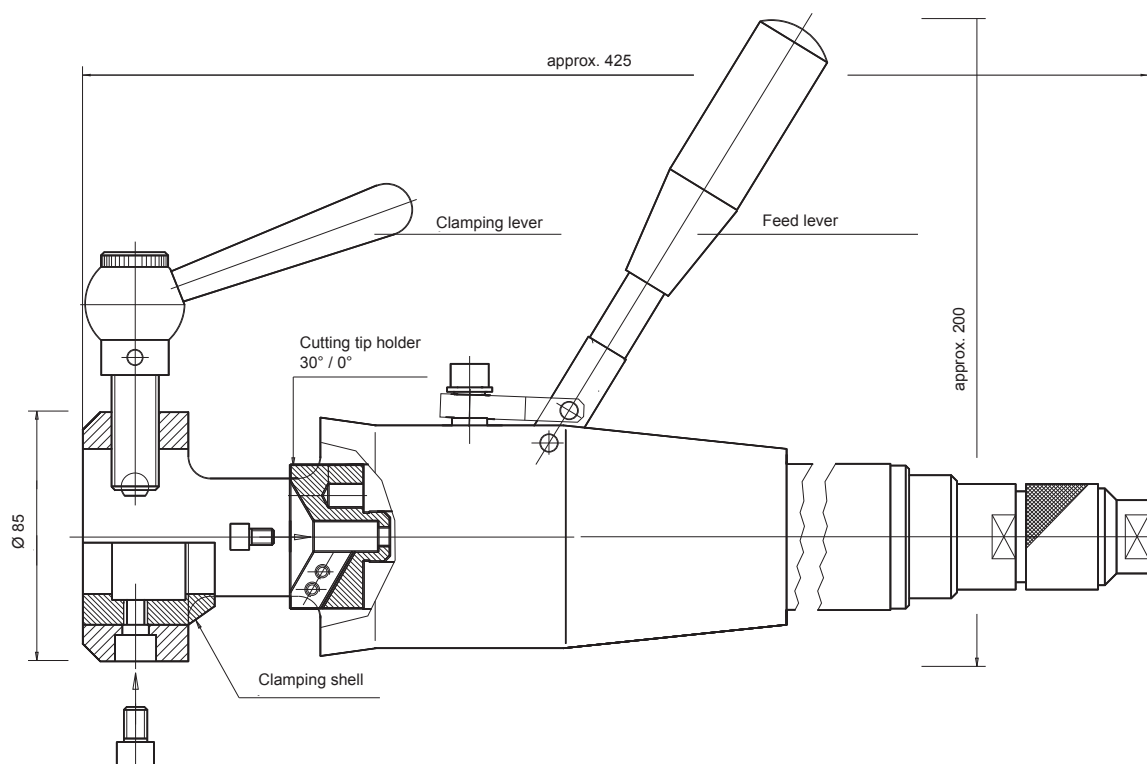
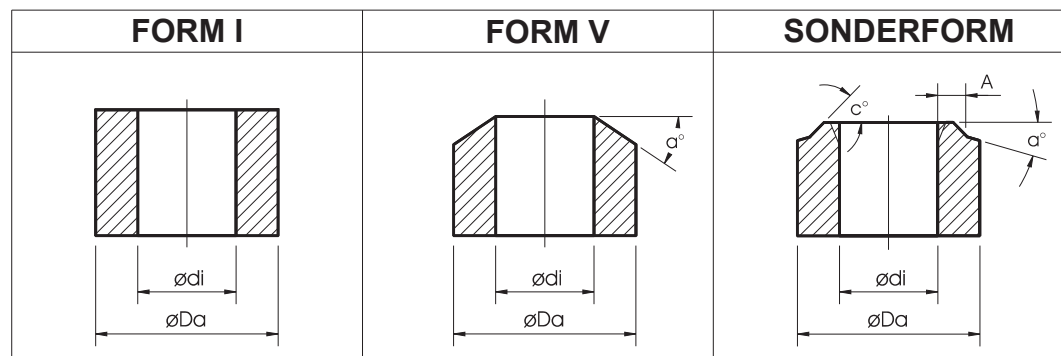

# CUTTING TOOLS

for the tube end milling unit Type **MF3-R**



091501105  
HSS  
cutting tool tip 0°



091501028  
HSS  
cutting tool tip 30°



091501106  
HSS  
cutting tool tip 0° (TIN)



091501108  
HSS  
cutting tool tip 30° (TIN)

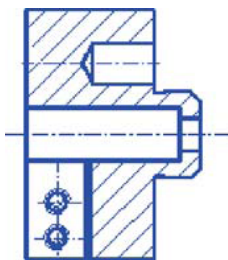

091502825  
Tool tip holder 0°

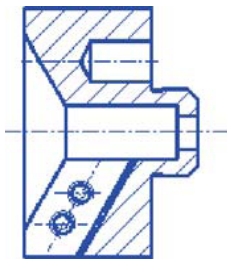

091502824  
Tool tip holder 30°

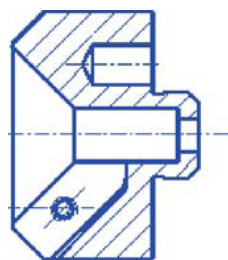

091502999  
Tool tip holder 45°

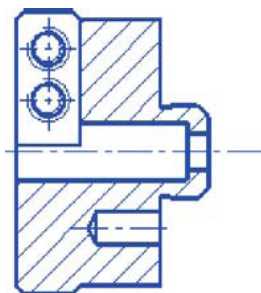

091502870  
Blade holder for  
special blades



Various special blades on request!